

**Warning:** The K&N Drycharger included with this kit must be installed on the K&N air filter when used with a K&N Typhoon Cold Air Intake System. The K&N Typhoon Intake System is a performance product that can be used safely during mild weather conditions. During harsh and inclement weather conditions, you must convert your Cold Air Intake System to a short ram configuration, or return your vehicle to the stock OEM airbox and intake tract configuration. Failure to follow these instructions can void your warranty.

## INSTALLATION INSTRUCTIONS

### 69-8605

**Toyota Scion**  
2003-07 XB  
L4-1.5L

**NOTE: E.O.# D-269-30**  
**APPLIES TO 2003-2005**

**TOOLS NEEDED:**

Flat Blade Screw Driver  
Phillips Screw Driver  
3mm Allen Wrench  
Ratchet  
Extension  
10mm Socket

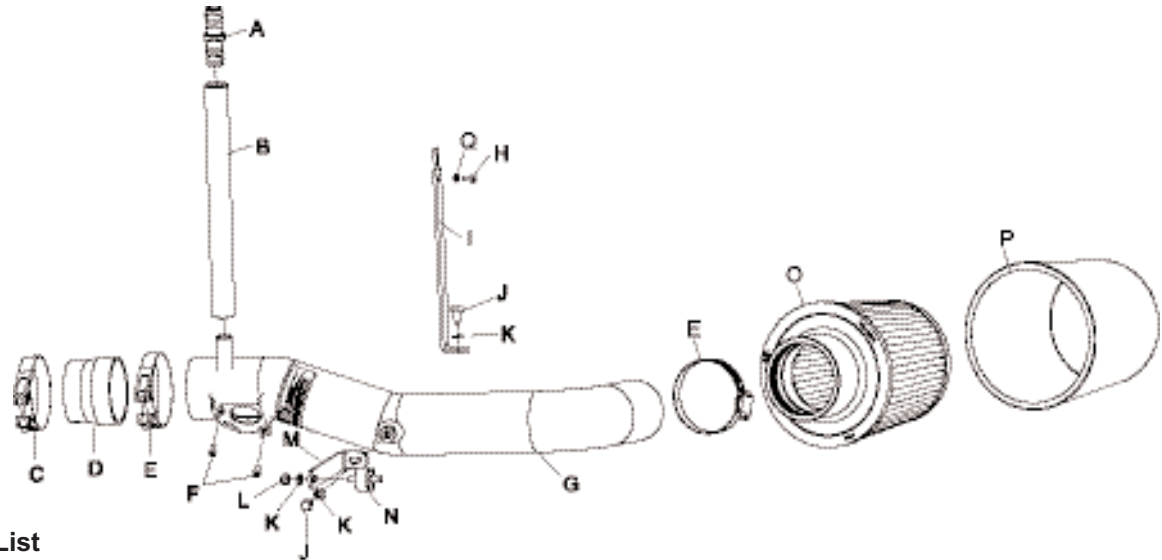

**Parts List**

**NOTE: FAILURE TO FOLLOW INSTALLATION INSTRUCTIONS AND NOT USING THE PROVIDED HARDWARE MAY DAMAGE THE INTAKE TUBE, THROTTLE BODY AND ENGINE.**

Description	Qty.	Part #	Description	Qty.	Part #
A VENT; 5/8" HOSE	1	08048	H BOLT; M5-0.8 X 12MM B/H, SS	1	07734
B HOSE; 5/8" ID X 9-3/4" L, BLACK	1	084047	I BRACKET; "L" LONG 69-8605	1	010044
C HOSE CLAMP; #40	1	08554	J BOLT; M6-1.00 X 12MM, HEX, SS	2	07727
D HOSE; 2-1/4" TO 2-1/2" X 2" L, STEP; BLACK	1	08476	K WASHER; WAVE, 6MM, SS	3	08277
E HOSE CLAMP; #44	2	08560	L NUT; 6MM, NYLOCK, SS	1	07512
F BOLT; M4-0.4 X 8MM, C/H/A	2	07733	M BRACKET; "L" SHORT 69-8605	1	010040
G TYPHOON INTAKE TUBE	1	27524	N STUD; RUBBER MOUNT, 6MM	1	07027
			O AIR FILTER	1	RU-4860
			P DRYCHARGER, BLUE	1	RX-4730DL
			Q WASHER; 5MM FLAT, SS	1	08212

**TO START:**

1. Turn the ignition OFF and disconnect the vehicle's negative battery cable.

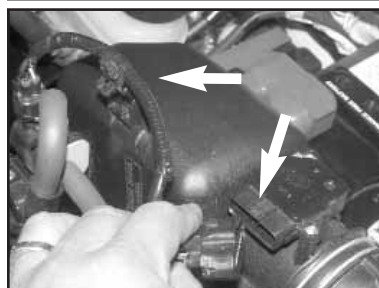

2. Disconnect the mass air sensor electrical connection and unclip the wire harness from the side of the air cleaner assembly as shown.  
**NOTE: On '06 & later models, unclip the MAS wiring harness from air box lid.**



3. Pull firmly upwards to remove the PWM vacuum switching valve from the side of the air cleaner assembly as shown.

**NOTE: On '06 & later models, the removal process of the PWM will be at step #6.**



4. Disconnect the crank case vent hose from the stock intake tube as shown.



5. Loosen the hose clamps at the throttle body and at the air cleaner assembly, then, remove the stock intake tube as shown.



6. Release the clamps on the upper air cleaner assembly, then, remove the upper air cleaner assembly as shown.

**NOTE: On '06 & later models, lift the air box lid and loosen and remove the screw that secures the PWM switch**

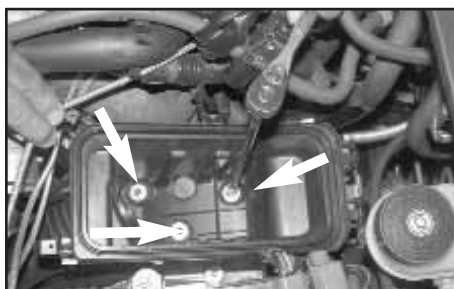

7. Remove the three screws that secure the lower air cleaner assembly as shown.



8. Loosen and remove the bolt that secures the air inlet tube to the radiator core support as shown.



9. Pull upwards to remove the lower air cleaner assembly as shown.



10. Remove the plastic wire harness clip that secures the mass air wire to other miscellaneous wires as shown.



11. Remove the tape that binds the three wire harnesses together.

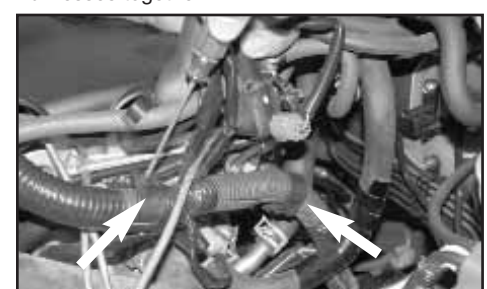

12. Unclip the two plastic wire harness clips and slide the wire harness forward to gain more slack for the mass air sensor electrical connection as shown.



13. Raise the vehicle up and support it with jack stands as shown.



14. Remove the two screws that secure the inner fender valance.



15. Remove the plastic rivet from the inner fender valance as shown.



16. Install the silicone hose and hose clamps onto the throttle body and tighten as shown.



17. Using the provided hardware secure the provided large "L" bracket to the original air cleaner mounting bracket as shown.



18. Slide the PWM vacuum switching valve onto the "L" bracket from the previous step.  
**NOTE: On the '06 & later models, using the supplied washer and bolt, secure the PWM vacuum switching valve to the "L" bracket as shown.**



19. Install the provided rubber mounted stud into threaded hole on the radiator core support from step 8.



20. Secure the short "L" bracket to the rubber mounted stud from the previous step using the provided hardware but do not tighten at this time.



21. Remove the mass air sensor from the upper air cleaner assembly as shown.



22. Install the stock mass air sensor into the K&N Typhoon cold air tube and secure with the provided hardware as shown.

**NOTE: Before installing the mass air sensor, inspect the inside of the tube for any debris, then clean the inside out with water and a towel. Inspect the tube one more time before proceeding to the next step.**



23. Slide the K&N Typhoon cold air tube into the area directly below the headlight as shown.



24. Rotate the end of the K&N Typhoon intake tube downward, then slide the other end of the tube into the silicone hose on the throttle body as shown but do not tighten at this time.



25. Line up the bracket from step 20 with the threaded boss on the K&N Typhoon cold air tube, then secure it using the provided hardware as shown, but do not tighten at this time.



26. Adjust the tube for best fit then tighten the bracket and the hose clamp as shown.



27. Install the provided hose mender into the provided silicone hose as shown.

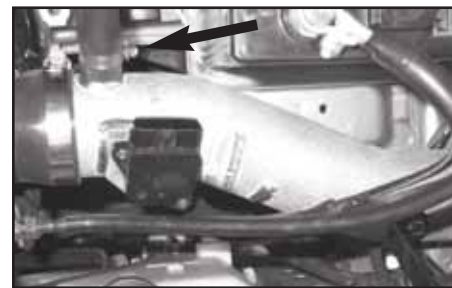

28. Slide the hose mender into the stock crank case vent hose, then, connect the other end to the vent on the K&N Typhoon cold air tube as shown.



29. Reconnect the mass air sensor electrical connection as shown.



30. Install the K&N Drycharger onto the K&N Air filter as shown.



31. From underneath the vehicle pull the inner fender valance down, then, slide the Air filter onto the cold air tube and secure with the provided hose clamp.

32. Reverse the removal process and secure the inner fender valance.



33. Re-connect the negative battery cable and double check that everything is tight and properly positioned before starting the vehicle.

34. The C.A.R.B. exemption sticker, (attached), must be visible under the hood, so that an emissions inspector can see it when the vehicle is required to be tested for emissions. California requires testing every two years, other states may vary.

35. It will be necessary for all Typhoons to be checked periodically for realignment, clearance and tightening of all connections. Failure to follow the above instructions or proper maintenance may void warranty.

#### ROAD TESTING:

1. Start the engine with the transmission in neutral or park, and the parking brake engaged. Listen for air leaks or odd noises. For air leaks secure hoses and connections. For odd noises, find cause and repair before proceeding. This kit will function identically to the factory system except for being louder and much more responsive.

2. Test drive the vehicle. Listen for odd noises or rattles and fix as necessary.

3. If road test is fine, you can now enjoy the added power and performance from your kit.

4. K&N suggests checking the Air filter element periodically for excessive dirt build-up. When the element becomes covered in dirt (or once a year), service it according to the instructions on the Recharger service kit, part number 99-5000 or 99-5050.

**\*FREE K&N DECAL To register your warranty, please see us online at [knfilters.com/register](http://knfilters.com/register). FREE K&N DECAL\***