



TYPHOON INTAKE SYSTEMS

INSTALLATION INSTRUCTIONS

69-8432

PONTIAC / SATURN

2006-08 Solstice

2007-08 Sky

I4-2.4L

TOOLS NEEDED:

Flat blade screw driver
 Phillips screw driver
 Pliers
 Ratchet
 Extension
 10mm socket
 3mm allen wrench
 T30 TORX wrench
 13mm socket

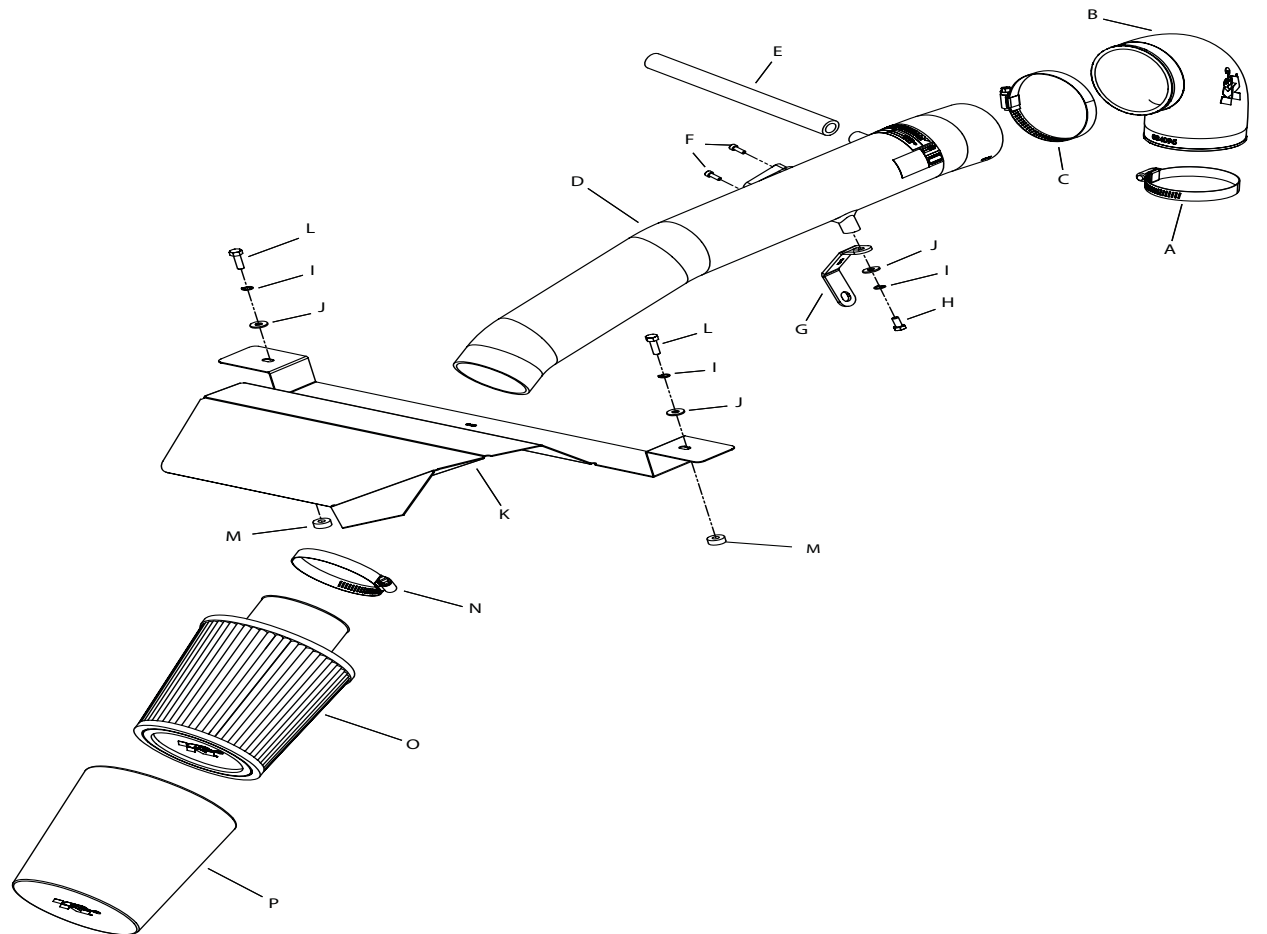

PARTS LIST:

Description	Qty.	Part #	Description	Qty.	Part #	Description	Qty.	Part #
A Hose Clamp #44	1	08560	G Bracket; "C", stl. fb/pc	1	06484	M Spacer; .625"odx.250"idx.250"l	2	06555
B Hose; 2-3/4" id to 3" id elbow	1	084087	H Bolt; 6mm-1.00x16mm, ss	1	07812	N Hose Clamp #52	1	08610
C Hose Clamp #48	1	08601	I Washer; 1/4" lock, zn	3	08198	O Air Filter	1	RU-4990
D Intake Tube	1	27135	J Washer; 6mm flat, ss	3	08269	P Drycharger Wrap	1	RX-4990DK
E Hose; 1/2" id x 9" l	1	08401	K Heat Shield	1	07349			
F Bolt; m4-0.07 8mm, a/h cap	2	07733	L Bolt; m6x1.00"x20mm hex, ss	2	07795			

WARNING: The K&N® Drycharger® included with this kit must be installed on the K&N® air filter when used with this K&N® cold air intake system. The K&N cold air intake system a performance product that can be used safely during mild weather conditions. During harsh and inclement weather conditions, you must convert your cold air intake system to a short ram configuration, or return your vehicle to the stock OEM air box and intake tract configuration. Failure to follow these instructions can void your warranty.

NOTE: FAILURE TO FOLLOW INSTALLATION INSTRUCTIONS AND NOT USING THE PROVIDED HARDWARE MAY DAMAGE THE INTAKE TUBE, THROTTLE BODY AND ENGINE.

TO START:

1. Turn off the ignition and disconnect the negative battery cable.

NOTE: Disconnecting the negative battery cable erases pre-programmed electronic memories. Write down all memory settings before disconnecting the negative battery cable. Some radios will require an anti-theft code to be entered after the battery is reconnected. The anti-theft code is typically supplied with your owner's manual. In the event your vehicles' anti-theft code cannot be recovered, contact an authorized dealership to obtain your vehicles anti-theft code.



2. Lift firmly on the engine cover to dislodge it from the mounting grommets and then remove the engine cover assembly.



3. Depress the locking tab and then disconnect the mass air sensor electrical connection.



4. Using pliers, release the hose clamp which secures the crank case vent hose to the valve cover and then remove the crank case vent hose from the valve cover as shown.



5. Loosen the hose clamp which secures the stock intake tube to the throttle body.



6. Release the six upper air box mounting clips.



7. Firmly lift up the intake tube and upper air box to release it from the mounting grommets and then remove the assembly from the vehicle.



8. Remove the front lower air box mounting bolt shown.



9. Pull up firmly to release the lower air box housing from the mounting grommets and then remove the lower air box from the vehicle.



10. Remove the right lower air box mounting studs shown from the bracket.



11. Remove the left lower air box mounting studs shown from the bracket.



12. Remove the two screws securing the mass air sensor to the stock intake tube and then remove the mass air sensor as shown.



13. Install the mass air sensor into the K&N intake and secure with the provided screws.



14. Install the K&N drycharger onto the K&N filter as shown.
NOTE: Please be aware the Drycharger® is water repellent, not water proof. Depending on conditions and usage the water repellent treatment is good for 1 to 2 years. See the parts list to reorder a new Drycharger® if necessary.



15. Install the K&N filter assembly onto the K&N intake tube and secure with the provided hose clamp.



16. Install the provided silicone elbow hose onto the throttle body and secure with provided hose clamp.



17. Install the heat shield assembly and secure to the air box mounting points, then secure with the provided hardware.

NOTE: It will be necessary to use the provided spacers between the heat shield and air box mounting points on the Saturn Sky vehicles.



18. Remove the upper alternator mounting bolt.
NOTE: This bolt will be reused in the next step.



19. Install the tube mounting bracket onto the alternator and secure with the bolt removed in the previous step.



20. Install the K&N intake tube assembly into the silicone hose at the throttle body and align with the mounting bracket installed in the previous step. Secure the tube with the hose clamp and hardware provided.



21. Install the supplied crank case vent hose onto the valve cover and onto the K&N intake as shown.
NOTE: Some trimming of the hose may be necessary.



22. Connect the mass air sensor electrical connection.



23. Reinstall the engine cover.



24. Reconnect the vehicle's negative battery cable. Double check to make sure everything is tight and properly positioned before starting the vehicle.

25. It will be necessary for all K&N® high flow intake systems to be checked periodically for realignment, clearance and tightening of all connections. Failure to follow the above instructions or proper maintenance may void warranty.

ROAD TESTING:

1. Start the engine with the transmission in neutral or park, and the parking brake engaged. Listen for air leaks or odd noises. For air leaks secure hoses and connections. For odd noises, find cause and repair before proceeding. This kit will function identically to the factory system except for being louder and much more responsive.

2. Test drive the vehicle. Listen for odd noises or rattles and fix as necessary.

3. If road test is fine, you can now enjoy the added power and performance from your kit.

4. K&N Engineering, Inc., suggests checking the air filter element periodically for excessive dirt build-up. When the element becomes covered in dirt (or once a year), service it according to the instructions on the Recharger® service kit, part number 99-5050 or 99-5000